

SDI

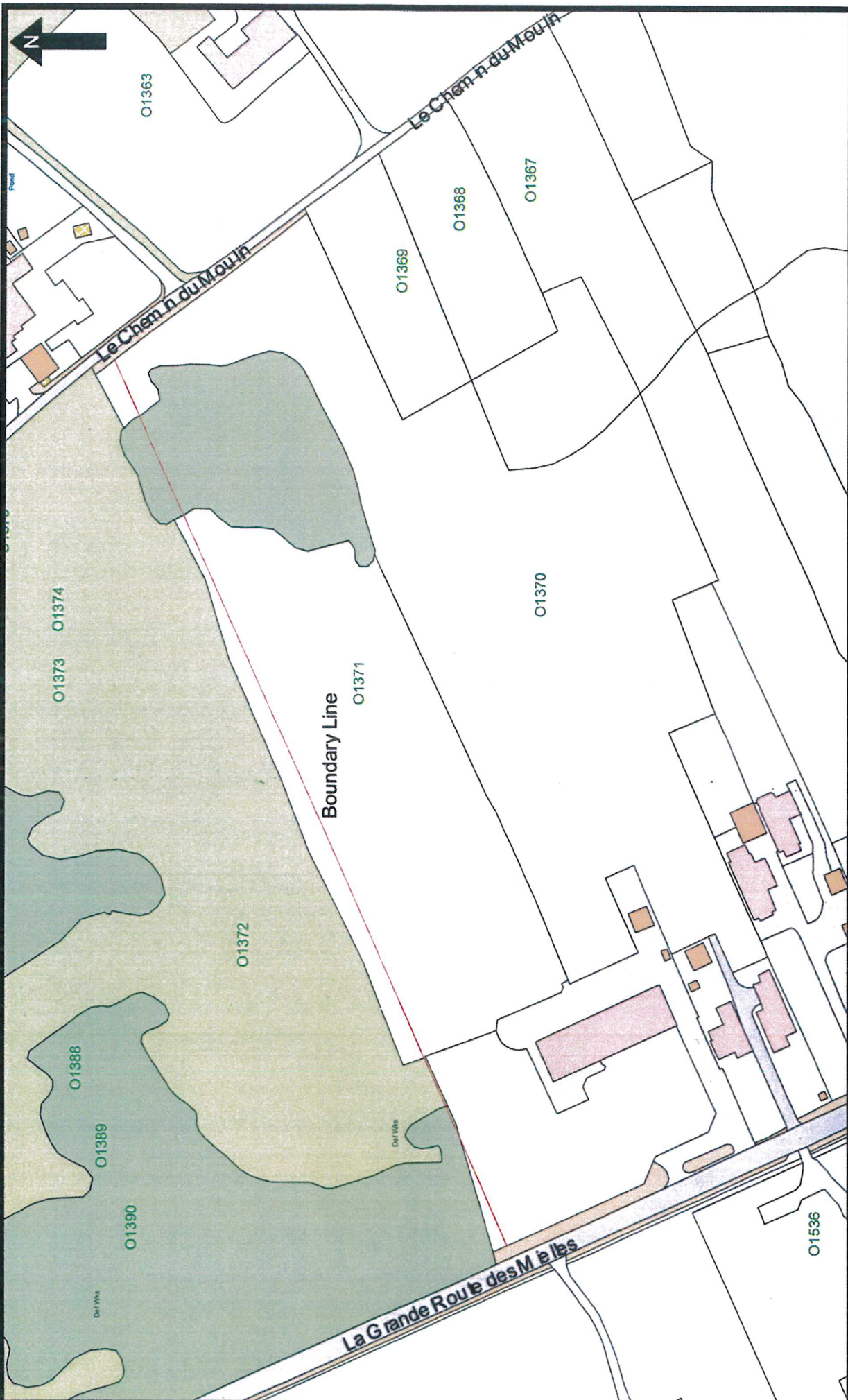

PROFESSIONAL HI-TECH SERVICES LIMITED**CONSULTING LAND SURVEYORS**

P.O. Box 709, St. Helier, Jersey, Channel Islands, JE4 0PP
Facsimile 01534 742482 Telephone 01534 742482

**Field 1371 Les Mielles de Morville
St Ouen****Survey Report & Analysis**

The determination of the position of the northern boundary of the Field 1371

1.0 Introduction

The northern boundary of Field 1371 is physically defined in the contract of sale as a bank with offset belonging to field 1372.

The bank has disappeared and the only physical separation that exists today is a line of trees.

It has been claimed that the line of trees was originally planted 12 feet to the north of the boundary.

2.0 Aim

The aim of this analysis is to mathematically define the boundary and physically set it out on site.

3.0 Data used in the analysis**Conveyencing Data**

Physical description of boundaries, measurements and data contained in extracts of the following deeds of sale were used in the analysis:

Sale No 1 by Francois Godfray to Phillip Hamon, 05/07/1856-215/27

Sale No 2 by Francois Godfray to George Mauger & Dlle. Elizabeth Gaillard, his wife, 05/07/1856-215/31

Sale No 3 by John Phillip Le Gresley to Fred Clarke, 21/09/1929-406/55

Sale No 4 of Weston's Grill by Brian Barette to The Scout Association 21/03/1997

Survey Data

A precise survey of the west of the site was original undertaken in August 1997.

Further survey work was carried out in June 2001 in order to produce a complete digital survey of the whole site that was used as the basis of the subsequent analysis.

Both surveys were undertaken using electronic total station equipment giving a positional accuracy of +/-10mm.

SD2

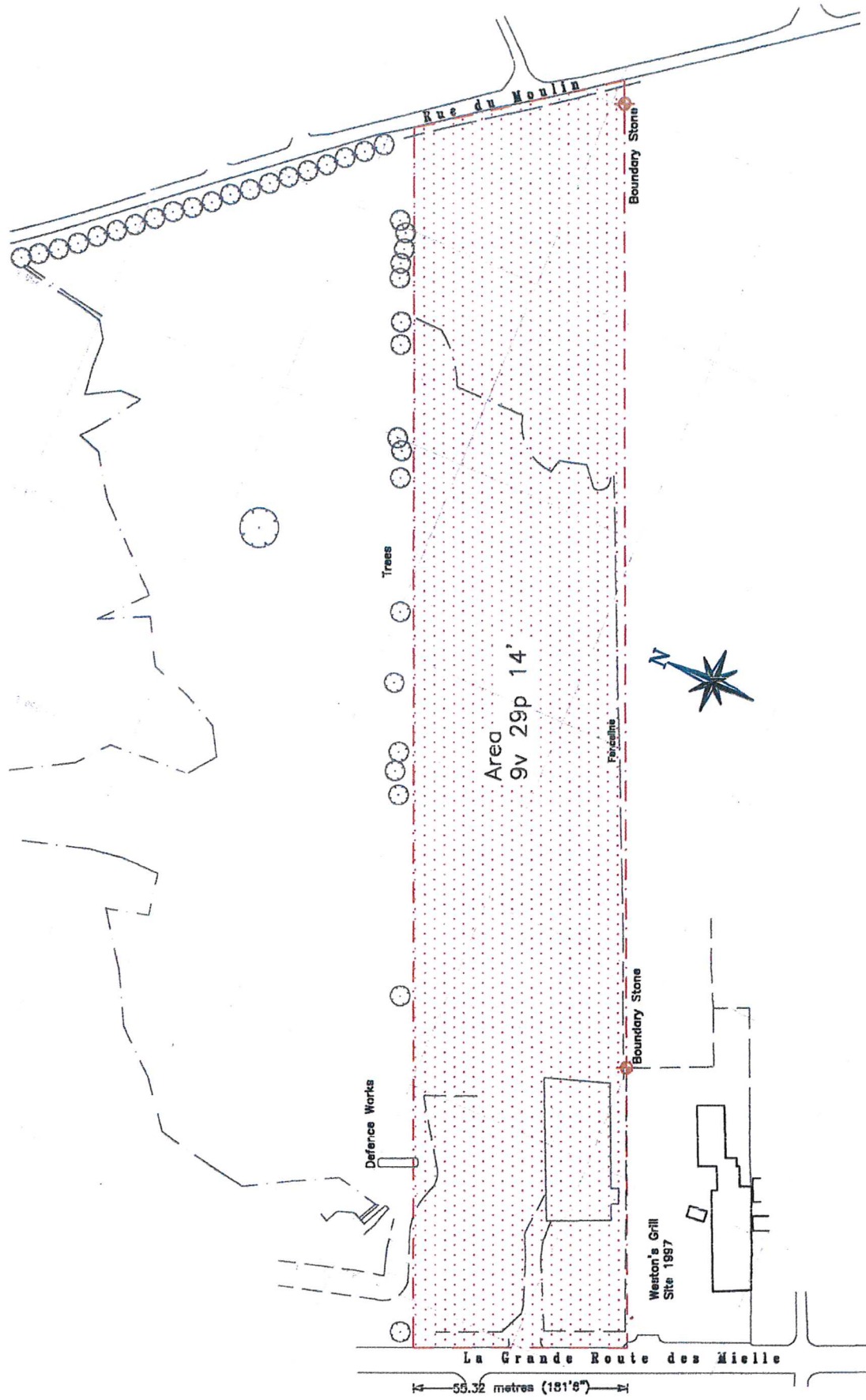

Surveyor : Paul & Aisla Trilling
 Date : November 2001
 Scale : 1-1000

Drawing Number : P514-01

BOUNDARY ANALYSIS
North Boundary Field 1371 ST OUIEN

Professional It-Tech Services Ltd
 Commercial Unit Singapore
 PO Box 70
 Jersey JE1 0SP
 Tel/Fax : 01 534 742482 Email : Eaurvoj247@cs.com

SD3

Drg. No. M784 / 01

LOCATION MAP, DRAWING COPYRIGHT RESERVED BY

Leeward

Red Roof

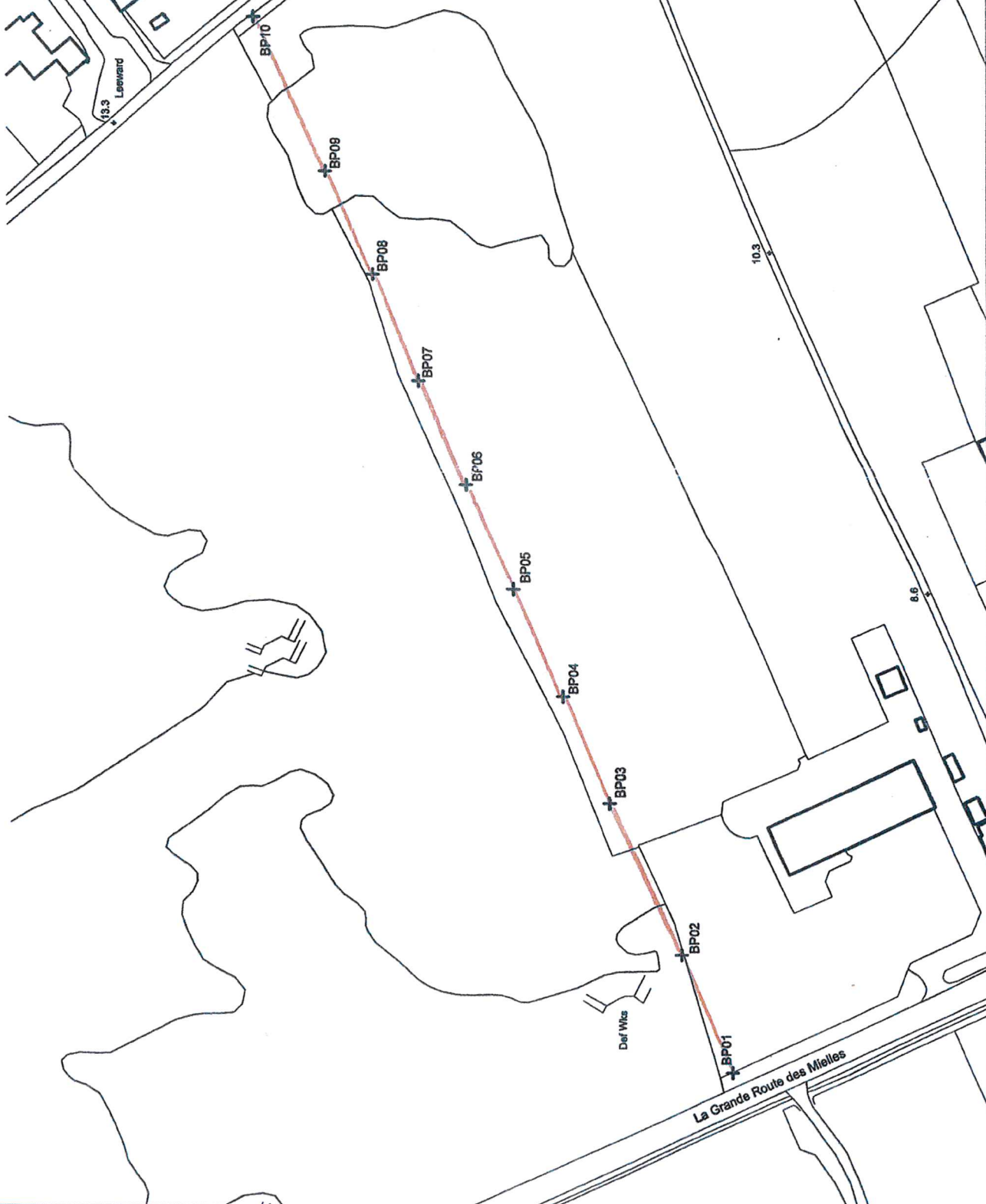

REV	DATE	BY	DESCR
STATES OF JERSEY TRANSPORT & TECHNICAL SERVICES DEPT			
PROJECT NORTH BOUNDARY, FIELD #37, LES MIELLES DE MORVILLE, ST OULÉN			
TITLE BOUNDARY SURVEY			
Checked By:	Drawn By:	Scale:	1:1000
Drg. No. M784 / 01			